

BUSINESS SEMINAR FRENCH ARCHITECTURE IN SAUDI ARABIA

Meet the French Trade Delegation Ready to Design the Cities of Tomorrow!



Saudi Arabia

Riyadh, Jeddah, AlUla

October 09 - 13, 2022



BUSINESS FRANCE

Business France is the national agency supporting the international development of the French economy, responsible for fostering export growth by French businesses, as well as promoting and facilitating international investment in France.

It promotes France's companies, business image and nationwide attractiveness as an investment location, and also runs the VIE international internship program.

Business France has 1,500 personnel, both in France and in 58 countries throughout the world, who work with a network of partners.

Since January 2019, as part of the reform of the state support system for exports, Business France has given private partners responsibility for supporting French SMEs and mid-size companies in the following markets: Belgium, Hungary, Morocco, Norway, the Philippines and Singapore.

For further information, please visit: www.businessfrance.fr @businessfrance.fr

Business France

77 boulevard Saint-Jacques

75680 Paris Cedex 14

Tél.: +33 (0)1 40 73 30 00





WORD FROM THE AMBASSADOR OF FRANCE TO THE KINGDOM OF SAUDI ARABIA



**AMBASSADE
DE FRANCE
EN ARABIE
SAOUDITE**

*Liberté
Égalité
Fraternité*

The construction sector has been a pillar of the Saudi economy for more than 30 years, and it became crucial with the Saudi Vision 2030 that aims to modernize and develop its social and tourism industry infrastructure, and preserve its cultural and natural heritage. The Kingdom has unveiled \$104 billion worth of real estate projects since the launch of the Saudi Vision 2030. The Kingdom plans to build more than 555,000 residential units, more than 275,000 hotel rooms and more than 4.3 million m² of commercial space. Those projects are a great opportunity for the French companies looking for new partners and business in Saudi Arabia.

Moreover, The Kingdom's population is expected to continue to grow and generate an increased housing demand in the coming decades.

France is and will remain a strategic partner to the Kingdom in many sectors such as energy, smart cities, tourism, hospitality, art and culture, archaeology and heritage, agriculture, health, training and many more, sharing the same vision of a sustainable and eco-friendly development model. The exceptional Saudi-French cooperation for Al Ula, Saudi Arabia's first UNESCO world heritage site, acknowledges the committed relationship between Saudi Arabia and France.

The regularity of high-level visits and meetings testifies to the solidity of this strategic partnership and marks the common will to enrich, with the impetus given by Vision 2030. This partnership was at the centre of discussions during the visit to Jeddah of the President of the Republic Emmanuel Macron in December 2021 and during the visit to Paris of HRH the Crown Prince Mohammed bin Salman in July 2022.

With a worldwide reputation for excellence and sustainability, French architects, urban planners, and landscaping agencies have a long history in playing pioneering roles in many projects internationally, from ancient prominent styles to modern and contemporary architecture. Several French companies are well established in the Kingdom, and Business France, the national agency supporting the international development of the French economy, is aiming through its mission to see more French companies taking part of the huge transformation of the Kingdom and achieving its Vision.

I am delighted to introduce to you a delegation of companies, members of the French Overseas Architects Association -AFEX, headed by Mrs. Madeleine HOUBART, AFEX Secretary General and Mr. Reda Amalou, AFEX's President. The members of the delegation are visiting Saudi Arabia (Riyadh, Jeddah and AlUla) to explore opportunities and are committed to develop, a strong and long-term partnerships. AFEX is a non-profit association with more than 200 members of architecture firms engineers, planners, landscape architects and manufacturers.

Long live the Saudi-French partnership!



HE Ludovic PUILLE

Ambassador of France to Kingdom Saudi Arabia



OUR PARTNER

Architectes
Français
à l'Export

AFEX

AFEX

24 Place des Vosges
75003 Paris



Reda AMALOU

Président



Madeleine HOUBART

Secrétaire Générale
Tél.: +33 (0)1 42 76 08 10
Mob.: +33 (0)6 80 08 34 05
afex@afex.fr

www.afex.fr

AFEX and its members are very happy to be back in Saudi Arabia, barely a year after our first visit. In the meantime, we have continued, with the valuable support of our French Embassy, to forge ties and get closer to this brilliant country.

For example, at the Mipim in Cannes, where KSA inaugurated a remarkable presence, we were able to animate a talk between leading Saudi actors and French architects about the mutual achievements of our two nations.

Our delegation, made up of many great French professionals, is committed to establishing and pursuing a constructive dialogue on the objectives and means available for meeting the challenges of development.

At a time when Saudi Arabia projects itself into 2030 and beyond, through many strategic projects and contemporary utopias, we wish to propose a French vision, focused on projects rooted in the historical, cultural and natural context of this great country.

We come to share our experiences, present the best of our know-how, and hear about the Saudi projects that will change your world and therefore ours.

Let's do it together !

Madeleine Houbart

Secrétaire Générale de l'AFEX



WELCOME TO FRANCE

France is a European leader in the construction industry with more than 400,000 companies, 1,477,000 employees and €140 billion in annual turnover (including 6,6 billion for export).

France gathers more than 30,000 architects recognized for their expertise, capable of combining aesthetics and sustainability, innovation and creativity. Thanks to its rich architectural history, France emerged as a leader in heritage conservation and rehabilitation.

Besides, french engineering accounts for 6% of the global market in terms of sales.

AFEX, a non-profit association with more than 200 members, plays the key role of promoting the savoir-faire of French architects, engineers, planners, and landscape architects abroad.



#1 MOST ATTRACTIVE COUNTRY IN EUROPE FOR FOREIGN INVESTORS



INTERNATIONAL ABROAD PROJECTS: 25% IN THE CULTURAL FIELD, 12% IN TOURISM, 11% IN THE TERTIARY SECTOR AND 8% IN URBAIN DESIGN



SUSTAINABILITY AND ENERGY CONSUMPTION REDUCTION ARE CENTRAL COMPONENTS OF PROJECTS



FRENCH ARCHITECTS WORK ON BIG SCALE PROJECTS IN THE WORLD'S LEADING DESTINATIONS AND CAPITAL CITIES



Creative by nature, industrial by tradition, strongly innovative, France invents the industry of tomorrow and inspires the future. Its industry stands out through strong abilities, techniques and a unique savoir-faire. La French Fab is the new inspiration for industry.

La French Fab supports a more digitized and respectful industrial era, deeply committed to designing disruptive and innovative industrial processes, always seeking to preserve an equal balance between working conditions and well-being. Passionate about energy efficiency and limiting the impact on the environment, France is at the cutting-edge of the digital transition, leading the next eco-industrial revolution, the “solutions’ revolution”.

La French Fab also aims at sharing responsible good practices and industrial savoir-faire to connect talented people for more inclusive and competitive jobs in a protected environment. Renowned for its excellence, and with a strong avant-garde spirit, French manufacturing is at the forefront of the factory of the future.

Launched in 2017 by Bruno Le Maire, La French Fab brings together, under one common banner, the industrial ecosystem across France. Indeed, La French Fab is the new name of the French industry. And it has the highest ambitions! Collectively supported by the Alliance Industrie du Futur, Bpifrance, Business France, France Industrie, the Direction Générale des Entreprises and France’s regions, La French Fab highlights the French industrial expertise and savoir-faire, provides a vision to transform the industrial base, by connecting people, generations and territories, by implementing the use of disruptive solutions to answer today and tomorrow’s challenges, in France and abroad.

With La French Fab, experience industry in a new way. Together, let’s inspire a new world.

#FrenchFab
@LaFrenchFabTalk

www.lafrench-fab.com



PARTICIPANTS

| | |
|--|----|
| AIA Life Designers | 8 |
| AR Architectes..... | 9 |
| Archetype Group | 10 |
| Architecturestudio..... | 11 |
| Arte Charpentier | 12 |
| Atelier Pascal Gontier | 13 |
| Aw ² - Architecture Workshop..... | 14 |
| Architecture Workshop | 14 |
| Boa Light Studio..... | 15 |
| Concept Urbain | 16 |
| Delhom Acoustics | 17 |
| Enia Architectes..... | 18 |
| Jakob+Macfarlane..... | 19 |
| Koz Architectes | 20 |
| Rougerie+Tangram | 21 |
| Selux | 22 |
| Setec International..... | 23 |
| Sud Architectes | 24 |
| Terrell Group..... | 25 |
| Unanime..... | 26 |
| Valode & Pistre Architectes | 27 |
| VS-A + OP-EN | 28 |

AIA LIFE DESIGNERS



AIA ARCHITECTES

23 rue de Cronstadt
75015 PARIS
France

Simon TSOUDEROS

International Development Director
Ph.: +33 (0)1 53 68 93 00
Cel.: +33 (0)6 60 48 38 13
s.tsouderos@a-i-a.fr

Mahfoud BENNACER

Architect
Project Director
Ph.: +33 (0)1 53 68 93 00
Cel.: +33 (0)6 46 43 69 93
m.bennacer@a-i-a.fr

 AIA Life desingers

www.aialifedesingers.fr/news/

Founded in 1965, AIA Life Designers is a major multi-disciplinary consultancy company, providing a full range of combined expertise and services in architecture, engineering, as well as in project management, urban planning and sustainable

development. It is the No.1 architecture firm in healthcare sector in France.

Headquartered in Paris with several offices in main cities in France such as Nantes, Lyon and Bordeaux etc. the firm is also established in China, Geneva and Luxemburg. Diverse projects are implanted in more than 20 countries and regions throughout five continents.

AIA Life Designers is able to offer a high level of commitment and know-how in sectors where the specificity of the activities and the complexity of the functions require innovation and synergy. Our architects, engineers, economists, urban planners, landscape architects, BIM engineers and model makers collaborate in an atmosphere of open, interactive and diverse pedagogy.

Our key expertise in <Health and Well-being>, <Industrial Facilities>, <Urban Planning> and <Generative City> allows us a multi-disciplinary approach for each project



*Saint-Paul Hospital Centre - LA RÉUNION 30 500 sqm.
Delivery 2018*



IBN SINA HOSPITAL, RABAT 198 000 m² 1000 beds - Delivery 2025

AR ARCHITECTES



AR ARCHITECTES

20 Passage de la Bonne Graine
75011 PARIS
France

Ruba ALABED

Architect/Founder of AR
ARCHITECTES

Ph.: +33 (0)1 44 23 89 48

Cel.: +33 (0)6 88 23 49 89

r.alabed@ar-architectes.com

D-AW (Design-Architecture Workshop)

3606, Sheikh Abdallah Al Anqary St.
- Unit 1

7343-12254 Riyadh

Saudi Arabia (KSA)

www.d-aw.co/

Adnan Al Dawalibi

General director

Ph.: +966 56 999 5858

adnan@d-aw.com

 [ar-architectes](http://ar-architectes.com)

www.ar-architectes.com/
agency

AR ARCHITECTES is an agency located in Paris since 2003, specialized in sustainable architecture and landscaping. It has an approach that guarantees a low carbon footprint design on the environment and aims to create a satisfactory interior design for users.

AR ARCHITECTES provides to projects' owners the latest technologies in matter of energy control, waste and air control, sewage and rain water management by the use of plants and restoration of biodiversity.

Therefore, AR ARCHITECTES has many references in France and abroad using french environmental label HQE™ in:

Eco-building: hotels, industrial buildings, sewage water treatment plants and landfills...

Eco-urbanism and landscaping: eco-district, urban parks...

The agency has worked on several innovative and sustainable projects in Saudi Arabia (Jeddah and Al-Ula) and Qatar (Doha).

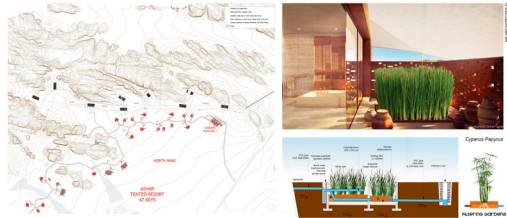

Eco-design of filtering gardens for grey and black water for Ashar tented resort hotel in Al-Ula (KSA) with AFALULA, AW2, EGIS

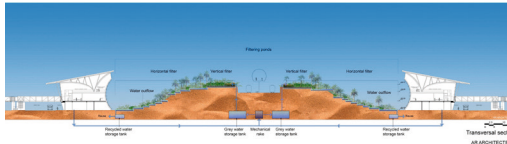

Eco-design of a filtering garden for grey water integrated into the Jeddah new terminal (KSA) with ADPI, TNPLUS, AEU.



Eco-design of the French Embassy in Doha (Qatar) – A bioclimatical architecture certified HQE™ Exceptional level (equivalent to LEED Platinum certification) with MATTA CONTRACTING, SUD ARCHITECTES, TEM PARTNERS, RBS, EUROPIMA.

ARCHETYPE GROUP



ARCHETYPE FRANCE

20 rue troyon
92310 SEVRES
France

Guillaume CROUZET

Business Development Director
Ph.: +33 (0)1 73 54 90 51
Cel.: +33 (0)6 60 08 65 76
guillaume.crouzet@archetype-group.com

HESCO

7994 Abtal Falastin
AR Ruwais District
23215 4211 Jeddah
KSA
www.hesco.es

Rifai HAMMADA

Ph.: +966 12 661 1194 - 150

 [archetype-group](https://www.linkedin.com/company/archetype-group)

www.archetype-group.com

With over 1,000 employees, Archetype Group is one of the leading private construction consultancies across 4 continents - Africa, Asia, Europe, and Latin America. With core services in Architecture & Master Planning, Building & Infrastructure Engineering, Industrial & Process Engineering and Project, Construction & Cost Management. Our expertise covers key construction sectors such as buildings & real estate, industry & manufacturing, and energy & infrastructure. Established in 2002, Archetype Group has been involved in numerous diverse projects. Our built references include prestigious real estate projects such as the MahaNakhon Tower in Bangkok, the Taj Mahal Palace in Mumbai, the renovation of the ADB Tower and of the Sofitel Ivoire in Abidjan, the Fairmont hotel in Djibouti, the Siem Reap International Airport, the Galeries Lafayette in Shanghai, and the Regional Council headquarters in Paris. Currently with 26 offices registered in 18 countries, Archetype Group has been working on over 1,500 projects in 50 different countries.



MahaNakhon Tower - Thailand



Sofitel Abidjan Hotel Ivoire – Ivory Coast



Taj Mahal Palace – India



Bai Tram Estates Resort – Vietnam

architecturestudio

ARCHITECTURESTUDIO

10 rue Lacuée
75012 PARIS
France

Roueïda AYACHE

Architecte associée

Ph.: +33 (0)1 43 45 18 00

Cel.: +33 (0)6 85 01 26 17

r.ayache@architecturestudio.fr

Founded in 1973 in Paris, Architecturestudio is an international practice based in Paris, Shanghai, and Zug, Switzerland. It brings around 13 partner architects a cosmopolitan team of 150 architects, urban, landscape and interior designers.

Nourished by a broad international experience, Architecturestudio's future-oriented design approach is based on:

- Plural understanding of the various contexts to design the resilient world of tomorrow
- Environmental awareness to respond to the 21st century major challenges
- Expertise in complex projects using BIM and parametric design tools
- Significant know-how in regenerating the architectural heritage
- Plural fields of expertise (Cultural, Tourism, Hospitality, Healthcare, Education, Offices, Housing and urban design)

Among Architecturestudio's major achievements are the European Parliament (Strasbourg), the Arab World Institute (Paris), the Eco district of Park Marianne (Montpellier), Onassis Cultural centre (Athens), the public realm design of Lusail City (Qatar), Bahrain National Theatre, Amman Rotana Hotel (Jordan), Jinan Cultural Centre (China)...



Amman Rotana Hotel



Bahrain National Theatre

 [as.architecture-studio](https://www.linkedin.com/company/as.architecture-studio)

www.architecturestudio.fr/en/

ARTE CHARPENTIER



ARTE CHARPENTIER ARCHITECTES

Maison Mozart
8 rue du Sentier
75002 PARIS
France

Nahla JAJO-LEGRAND

Project Director - International
Development at Arte Charpentier
Ph.: +33 (0)1 55 04 13 08
Cel.: +33 (0)6 22 62 15 39
n.jajolegrand@arte-charpentier.com

Martin JOVER

Architecte
Ph.: +33 (0)1 71 19 10 22
Cel.: +33 (0)6 11 85 07 71
m.jover@arte-charpentier.com

 [arte-charpentier](https://www.arte-charpentier.com/en/)

www.arte-charpentier.com/en/

Arte Charpentier, a global agency
Architecture.
Research.
Technique.
Environment.

We are a 360° agency, led by women and men capable of providing all the expertise, energy and enthusiasm necessary for the design and realisation of generous and animated spaces, from the simplest to the most complex. From the railings to the 5th facade, from the building to the territory.

Experts in cultural and patrimonial equipment, the tertiary sector, facilities, retail, housing and project management.

We are architects, urban planners, interior architects and designers, landscapers, researchers and doctoral students. Support by a team of IT specialists, BIM managers, graphic designers, financial managers, quality specialists, lawyers, communicators and assistants.

Founded in 1969, Arte Charpentier has more than 120 employees from 15 different nationalities, including 20 associates, in Paris, Lyon and Shanghai.



Campus Ducasse Paris, France © Arte Charpentier - Boegly Grazia



Opera of Shanxi, Taiyuan, China © Arte Charpentier - Shen Zhonghai

ATELIER PASCAL GONTIER

ATELIER PASCAL GONTIER

ATELIER PASCAL GONTIER

8, rue de Valois
75001 PARIS
France

Pascal GONTIER

Architect and CEO
Ph.: +33 (0)1 49 23 15 41
Cel.: +33 (0)6 76 71 90 41
pascalgontier@pascalgontier.com

Atelier Pascal Gontier (APG) is an architecture and urban development practice founded in 1997 by Pascal Gontier, DPLG architect and EPFL postgraduate. The Atelier's approach has been nourished since its origin by a pronounced taste for innovation and experimentation, as well as by a strong commitment and recognized expertise in sustainable development and ecological transition. The studio is also particularly focused on carrying out construction projects using wood and bio-sourced materials, and is a member of the ADIVBOIS association.

The practice delivered the Max Weber building in 2017 which is the first office building in France entirely built in wood. The project has been awarded the 2016 Green Building Low Carbon Award & the 2016 "Trophée Bois Ile-de-France" Award.



*Max Weber building
Paris Nanterre University
Nanterre, France*



*Paris 2024 Olympic Village
Saint Denis & Saint-Ouen, France*

 [atelier-pascal-gontier](https://www.linkedin.com/company/atelier-pascal-gontier)

www.pascalgontier.com

AW² ARCHITECTURE WORKSHOP



AW² - ARCHITECTURE WORKSHOP

74 rue Bonaparte
75006 PARIS
France
Ph.: +33 (0)1 45 87 75 75
aw2@aw2.com

Reda AMALOU
Founder & Partner

Stéphanie LEDOUX
Partner Architect

 [architecture-workshop2](https://www.linkedin.com/company/architecture-workshop2)

www.aw2.com/en

AW² is an international architecture and design studio based in Paris.

Reda Amalou graduated from the University of East London and founded the agency in 1997. Stéphanie Ledoux, a graduate from the Ecole Spéciale d'Architecture in Paris, joined AW² in 2000 and became a partner in 2003. With projects in 40 different countries, the agency has an international reputation for quality high-end design. The studio covers all project typologies including hospitality, education, commercial and residential.

AW² has received several awards over the years including the MIPIM Best Hotel Award for the Six Senses Con Dao resort, the Build Architecture Award for Best International Architecture & Design Studio – Paris, and four nominations for the AFEX Grand Prize in French Overseas Architecture for Six Senses Con Dao in Vietnam, the Lycée Français in Amman, Jordan, Ani Private Resort & Art Academy in Sri Lanka and Kasiya Papagayo eco-lodge in Costa Rica.



Banyan Tree AlUla, Kingdom of Saudi Arabia ©AW2



Resort 5 Silversands, Grenada ©Magda Biernat*

**BOA LIGHT
STUDIO**

BOA LIGHT STUDIO

SCOPARL

76, rue de Fontenay
94300 VINCENNES
France

Philippe STANFIELD PINEL

Associate

Ph.: +33 (0)1 43 98 20 20

Cel.: +33 (0)6 67 78 38 15

psp@boa.fr

Who we are

BOA Light Studio designs lighting atmospheres. A multidisciplinary collective at the crossroads between architecture, design and scenography, we create nightscapes: tales of light that make for a memorable and poetic nighttime experience.

What we do

To us, lighting design is about more than countering obscurity. Our creations combine elegance and innovation to tell a story that is relevant to a place's spatial, cultural and sensory context.

For each one of our projects, we develop a poetic narration, whether we're illuminating an office building, a commercial space, a temporary installation or an entire urban landscape.

Our lighting installations get noticed because they sculpt the space, giving it character and providing a unique sensory experience.

Having conducted projects in the USA, the Middle East, China and across Europe, BOA Light Studio has gained international recognition.



 [boalightstudio](https://www.linkedin.com/company/boalightstudio)

www.boa.fr

CONCEPT URBAIN



SAS

ZA N°3 LA FOSSE NEUVE
151 Allée de la Fosse Neuve
37210 PARCAY-MESLAY
France

Stéphanie DREUX

General Manager
Ph.: +33 (0)2 47 29 07 08
Cel.: +33 (0)6 80 11 90 31
s.dreux@concepturbain.fr

With 40 years of experience as a street furniture designer and manufacturer, Concept Urbain works cast iron, steel, aluminium and stainless steel in combination with wood or composite materials. Equipped with efficient industrial tools, Concept Urbain strives to offer top-quality products providing the best response to environmental constraints. With its complete lines of contemporary design street furniture, Concept Urbain offers technical responses for road problems and elegant solutions for landscaping, city centers and public spaces



Bubble Armchair



Soha transat

 Concept Urbain | LinkedIn

www.concept-urbain.fr/en/

DELHOM ACOUSTICS



DELHOM ACOUSTIQUE

ZA de Tourneris, Bonrepos sur
Aussonnelle,
31470 TOULOUSE
France

Lois DELHOM

International Business Development
Director

Ph.: +33 (0)5 61 91 64 90

Cel.: +33 (0)7 69 61 36 17

l.delhom@acoustique-delhom.com

One of the world's leading independent acoustic engineering and consultancy agencies, DELHOM ACOUSTICS started in France in 1995 where it developed significantly throughout the years both locally and internationally. Today they operate globally with their main agencies located in France, Vietnam and China.

Our 27 years of experience have enabled us to solve noise & vibration challenges in all types of environments including: buildings and interior spaces, performing art centers, transportation infrastructure, industrial facilities and windfarm projects.

Some of our selected experience include: Opera & Theater projects, Hotel & Resorts, Office & factory projects, infrastructure & acoustics for urban planning.

Some of our key partners & clients include: Gensler, GMP, Perkins Eastman, BIG, Woods Bagot, Ducks Sceno, Schuler Shook, AIA, Arte Charpentier, HBA, Ritz-Carlton, Waldorf Astoria, Mandarin Oriental, Club Med, IHG, Hilton, Marriott, Accor, Hyatt, Ubisoft, LEGO, BASF, TOTAL, AIRBUS, and more who have made the trustworthy choice to call on our acoustic expertise.

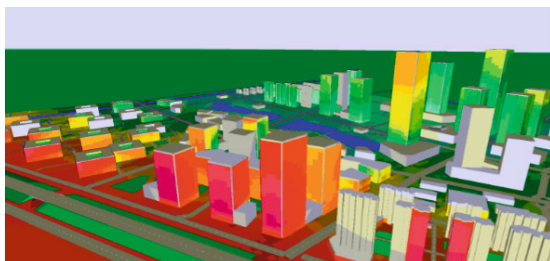

Environmental noise impact simulation on façade of buildings, to determine the appropriate façade treatments to reduce noise traveling inside the building.

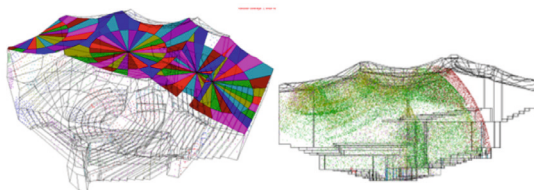

The acoustic design of performing arts centers is vital for the listening experience of both audience and performers. Here is a simulation of sound propagation and music clarity inside a concert hall.

 [delhomacoustique](https://www.linkedin.com/company/delhomacoustique)

www.acoustique-delhom.com

ENIA ARCHITECTES

enia ARCHITECTES

SAS ENIA ARCHITECTES

73 Victor Hugo street
93170 BAGNOLET
France

Atri JOSHI

Director
Ph.: +33 (0)1 84 03 04 10
studio@enia.fr

Founded in Paris in 2003, enia architectes is one of the top 60 architecture and design firms in France. Directed by 3 architects from a multi-disciplinary background – Brice Piechaczyk, Mathieu Chazelle and Simon Pallubicki - the office is supported by a solid and enthusiastic staff of 60 collaborators from 8 different nationalities. Our work spans a wide spectrum of building types and across all scales of operation such as religious and cultural facilities, data centers, educational buildings, sport facilities, transport, retails, offices or mixed us programs. In today's carbon-conscious world, we believe that creating responsible architecture is foremost about fabricating conditions for harmonious cohabitation, a symbiosis between man and environment constructed from a reasoned economy of resources.

Since 2005 enia architectes has actively developed our international activity with projects in China, Japan, Asia, Africa and Europe. The firm has partnerships in Tunisia, Brazil, Japan and an indian subsidiary since 2016.



Aéroport Pôle Caraïbes



Guinea hospital



Terminaux de croisières

[in enia-architectes](https://www.linkedin.com/company/enia-architectes)

www.enia.fr/en

**JAKOB+
MACFARLANE**

JAKOB+ MACFARLANE

JAKOB+MACFARLANE SAS D'ARCHITECTURE

13-15 rue des Petites Ecuries
75010 PARIS
France

Dominique JAKOB

President

Ph.: +33 (0)1 44 79 05 72

Cel.: +33 (0)6 87 74 34 56

jakobmacfarlane@gmail.com

Brendan MACFARLANE

Founding Partner

Ph.: +33 (0)1 44 79 05 72

Cel.: +33 (0)6 87 74 34 56

info@jakobmacfarlane.com

www.jakobmacfarlane.com/en

Jakob+MacFarlane is an architectural, urban planning and design office founded in 1998 in Paris, France by Dominique Jakob and Brendan MacFarlane. Rooted in innovation and social commitment, their work addresses environmental and other challenges of the 21st century. Projects by Jakob+MacFarlane become true urban markers combining societal value and unique architectural identity. The geography of their built and ongoing work ranges from France to Egypt, Belgium and China.

Key realised projects: L'Eclat Theater (Pont-Audemer, 2000); Renault Communication Center (Boulogne-Billancourt, 2004); Ricard Contemporary Art Foundation (Paris, 2007); Hérold Social Housing (Paris, 2008); Swiss Cultural Center (Paris, 2010); Orange Cube and Euronews TV Headquarters (Lyon, 2010-14); Docks – City of Fashion and Design (Paris, 2012); Contemporary Architecture Museum (Orléans, 2013); Music and Dance Conservatory (Noisy-le-Sec, 2017); biomedical research center Méary (Paris, 2017), Cineplex in Pont-Audemer, mixed-use complexes in Montpellier and La Rochelle (2020-21).



New campus of the French University of Egypt (Université Française d'Egypte), currently in progress in El-Shorouk, Cairo



The Docks / City of Fashion and Design, Paris, France - Photo © James Ewing



The Orange Cube (headquarters of Groupe Cardinal), Lyons, France - Photo © Roland Halbe

KOZ ARCHITECTES



KOZ ARCHITECTES

12 impasse Mousset
75012 PARIS
France

Nicolas ZIESEL [in](#)

Président

Cel.: +33 (0)6 71 66 07 66

nicolas@koz.fr

KOZ architectes was founded in 1999 by Christophe Ouhayoun and Nicolas Ziesel after graduating from the ENSA Paris-Belleville.

The office is located in Paris, focuses on wood building and has built projects in France and Mexico, and in design and construction in the Caribbean and Africa.

Current projects range from big to small: -from part of the athletes village for the 2024 Paris games, to research on local materials for a bioclimatic house in the Martinique island, and from residential to workspace, hospitality and leisure.

The office is full BIM, has a sustainable engineering department and is digital fabrication ready, with an in house CNC workshop opening soon.

The 25 people strong team adopted a 4 day work week a few years ago and still finds time to develop pro-bono activities. The most recent are a self built summer pavillon in the gardens of the Villa Medici in Rome, and an international student workshop in Kyoto. Both related to the office's involvement in the running of the Woodrise International Congress on high-rise and innovative wood construction.

Nicolas is associate teacher at the Architecture & Landscape school in Lille (ENSAPL), and organizes a « learning by doing » studio at the Abidjan School of Architecture (EAA).

He is VP of AFEX, associate member of Yes We Camp - a non-profit running transitory urbanism sites with a high cultural and social impact - and coordinates a Community Supported Agriculture group in Paris.



Sensations, Highest 100% wood structure project in France, Strasbourg, 2019



Small architecture Festival, Villa Médicis, Rome, 2022

[in](#) [koz-architectes](https://www.koz-architectes.com)

www.koz.fr

ROUGERIE+ TANGRAM

ROUGERIE+TANGRAM

ROUGERIE+TANGRAM

23 Rue des Phocéens
SAS - Code APE 7111Z
13002 MARSEILLE 02
France

Jacques ROUGERIE

Architect, Member of Institute
Ph.: +33 (0)1 42 66 53 37
Cel.: +33 (0)6 61 53 86 38
rougerie@rougerie.com

Located in Paris and Marseille, the international architecture, urban planning and landscape design agency Rougerie+Tangram creates innovative and emblematic facilities throughout the world;

It is driven by the desire to carry high the values of progress and innovation, ecology, collective intelligence and the spirit of biomimicry to build a sustainable future through projects on land, under the sea and in space.

Its creed: to produce an architecture of daring and surprise, always inspired by living beings, in a spirit of harmony between beings and nature, in order to Invent, Transform, Impact.

Invent solutions, invent practices, invent possibilities,
Transform ways of thinking, transform uses, transform society,

Impact the future, impact the course of things, impact the system.

The diversity of the agency's achievements, including cultural and scientific projects, museums, aquariums, sports facilities, airports, university buildings, public-access buildings, housing, etc., reveals the wealth of contemporary creativity that characterises it.

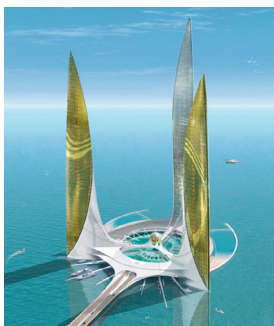

 [rougerietangram/](https://www.linkedin.com/company/rougerietangram/)

www.rougerie-tangram.com/en/

SELUX

selux

SELUX

Route de Tramoyes
Les Echets
01706 MIRIBEL
France

Edouard SACRE

Export Manager
Cel.: +33 (0)6 83 31 80 54
edouard.sacre@selux.fr

At Selux, we have been asking ourselves how to light places for more than 70 years. How do we create safety, well-being and beauty with light? How do our products work during the day when they are objects in public spaces? SELUX - always light. When Hermann Bansbach founds his company in Berlin after the Second World War, the badly destroyed city is almost without electricity and light. Bansbach brings light into the dark times by making life easier for Berliners with a battery charger. He believes that light has a social and cultural significance that goes far beyond the purely economic.

2022

We have retained this attitude to this day. We too experience the fascination of bringing people real quality of life with well thought-out lighting concepts. This is how Semperlux became Selux - and how a Berlin craftsman's business became a company that is at home all over the world with 400 dedicated employees and locations in Europe, North America and Australia. From our headquarters in Berlin, Lyon and New York, we drive forward our ideas of an extraordinary future and are convinced that the best solutions are created together, through listening and understanding. Openly, creatively and with high competence. Our tools are a comprehensive knowledge of technologies and materials, open communication and the enthusiasm to think in new ways.

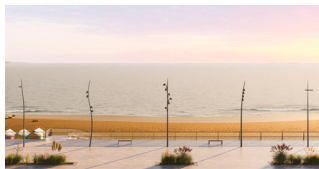

deco poles organic



Qatar Pearl House



Qatar Lusail Marina



Qatar Pearl House



www.selux.com/int/en

SETEC INTERNATIONAL



SETEC INTERNATIONAL

5 Chemin de Gorges de Cabries
13127 VITROLLES
France

Mauricio CABRERA

Head of International Business
Development
Ph.: +33 (0)1 82 51 41 27
Cel.: +33 (0)6 85 76 60 56
mauricio.cabrera@setec.com

setec tpi Consulting Engineers

Al Jumaiah Tower
Kingdom of Saudi Arabia
Riyadh
Arabie Saoudite

Yakin DABDA

Country Director
Ph.: (966) 4725333
yakin.dabda@setec.com



www.setec.com

Founded in 1957, Setec Group is now one of the French largest engineering firms. It has more than 3,300 staff worldwide with an annual turnover around €375 million. Its entire capital is held by the management executives and senior engineers. It is therefore completely independent of any contractors, banks, or industrial corporations.

The Setec group works on all stages of the life of a project, from feasibility studies to commissioning. For large, complex projects, the company provides a multidisciplinary team, led by a Senior Project Manager combining the skills of the company's top specialists in every field.

Setec group's fields of activity include, among others: economics & traffic engineering, transport infrastructures (roads and motorways, railways, public transport, airports, ports etc.), intelligent transport systems, railway systems, building, industry, energy, water and waste engineering, environmental protection, project management, strategy and organisation and urban planning & development.

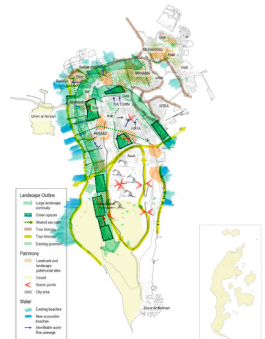

Photo 1: King Salman Park

Legende: Riyadh: King Salman Park Foundation has entrusted the GHS Joint Venture, composed of Gerber Architekten International, Buro Happold and setec, to design the King Salman Park, a 17,2km² park in the center of Riyadh. It is composed of 52 subprojects. This park is part of a strategy to green the city of Riyadh.

Photo 2: Bahrain French Town Planning Initiative, Master Planning

Legende: Technical assistance to the Kingdom of Bahrain as a part of a consortium composed of major engineering French companies Arep, Egis and Setec.



SUD ARCHITECTES

SUD

SUD ARCHITECTES SAS

27 rue Joannes Carret
C.S. 10711
69256 LYON CEDEX 09
France

Jean Marc PIVOT

Founding Partner
Ph.: +33 (0)4 78 64 07 07
Cel.: +33 (0)6 08 26 30 49
jmpivot@sudarchitectes.com

Benoit FAUCHERAND

CEO SUD Groupe SUD
Ph.: +33 (0)4 78 64 07 07
bfaucherand@arching.com

Fadi KOTOB

Partner
Ph.: 9613300835
Cel.: +33 (0)7 83 35 52 73
fkotob@sudarchitectes.com

SUD ARCHITECTES - KSA

Villa 3
Souliman AlTajel Street
Alhama District
23321 Jeddah
KSA

Fawzi SULAIMANI

General Manager
Ph.: +33 (0)5 33 09 90 97
fsulaimani@sudarchitectes.com

www.sudarchitectes.com

Founded in Lyon in 1986 and developed between Paris, Warsaw, Beirut, Shanghai and Jeddah; the partnership of 20 architects with different sensitivities and an extensive international's team, enable us to tackle ambitious projects, for varied solutions and manage all aspects of the contemporary city and historical sites: urban planning, retail, leisure, health care, hospitality, refurbishment, and interior design offering the distinctive French Touch and commitment to excellence. Based on the know-how of local and international standards, we own a reliable portfolio and extensive experience in design excellence and practice.

Our design concepts respond to the challenges of the modern service economy, the network society and new communication systems.

We aim to combine refined passive design with integrated renewable energy sources, state-of-the-art conservation techniques, new green technologies, services and utilities.

Through the systematic integration of green principles in all our designs, we contribute to the worldwide ecological values.



French Embassy Residence des Pins Beirut Lebanon



SEB global headquarters in Lyon France

TERRELL

Consulting Engineers since 1982

TERRELL GROUP

11 rue Heinrich
92100 BOULOGNE BILLAN COURT
France

Ziad DARGHAM 

Managing Director

Cel.: +33 (0)6 20 39 39 54

z.dargham@terrellgroup.net

Created in 1982, the Terrell group has become a leading international multi-disciplinary engineering consultancy, with headquarters in France and offices in the UK and the Middle East.

Terrell offers expertise in all major aspects of building engineering, from structural to MEP and façade disciplines, and has gained national & international renown working with leading architects while retaining a concentrated allegiance to their clients' core requirements by:

- optimizing engineering design
- balancing architectural requirements with budgetary constraints
- integrating all aspects of design within a full BIM framework
- using latest technology and expertise to achieve optimum buildability, speed of construction and value for money.

Environmental quality is at the heart of our projects aiming to deliver effective passive and active solutions to ensure low energy consumption.

We pride ourselves on the technological innovation we implement in the construction market and our pragmatic approach ensuring delivery of optimised design solutions.

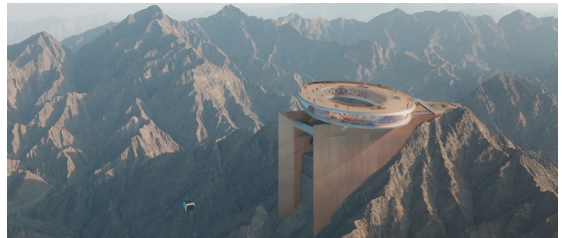

Hatta Mountain Dubai Summit Complex

Client: EDF & DEWA

Architect: Groupe-6

 [terrell](https://www.linkedin.com/company/terrell)

www.terrellgroup.net/en/

Luma Arles

Client: SCI Atelier d'Arles Immobilier

Architect: Frank Gehry

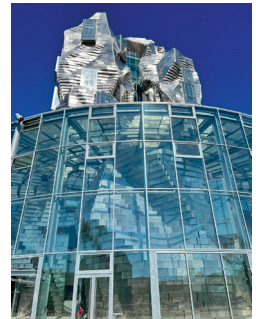

UNANIME

unanime
architectes

UNANIME ARCHITECTES LYON

3 RUE JANGOT
69007 LYON
France

Didier GARCIN 

Architecte Associe
Ph.: +33 (0)4 78 28 51 30
Cel.: +33 (0)6 74 67 44 11
d.garcin@unanime.fr

UNANIME ARCHITECTES GULF

EURO TOWER
SANNABIS
PO BOX 76 102
MANAMA
KINGDOM OF BAHRAIN

Pierre SFEIR 

GENERAL MANAGER
Ph.: 97 337 221 339
p.sfeir@unanime.fr

 [unanime-architectes](https://www.linkedin.com/company/unanime-architectes)

www.unanime.fr/en

UNANIME ARCHITECTES

We are more than 70 personnel, passionate about architecture, working out of four offices: Lyon, Aix-les-Bains, Paris and Manama (Kingdom of Bahrain). Wherever we are, we move forward in unanimity. Architects, town planners, designers, site managers, we have been practicing architecture with a multidisciplinary perspective for over 27 years. Our activities are based on the personal backgrounds, experience and skills of each of our personnel. This extensive capability is revealed in the appositeness and diversity of our architecture. Each project is prepared with the same attention and is the fruit of our reflective, functional and collaborative practices. We are involved in housing, education, research, health, industry and the service sector. For each project, our ambition is to find the balance between common sense and creativity. Our ability to design complex projects leads us to take up new challenges every day and to master a variety of subjects. This same dynamic motivates us to expand into new territories.



NEOM ADVANCED HEALTH CENTER

VALODE & PISTRE ARCHITECTES

Valode & Pistre

VALODE & PISTRE ARCHITECTES SARL

115 rue du Bac
75007 PARIS
France

Stéphane FERRIER

Secretary general, Partner
Ph.: +33 (0)1 53 63 22 00
stephane.ferrier@v-p.com

Mathew WIGGETT

Architect Director
mathew.wiggett@v-p.com

www.v-p.com/en

Valode&Pistre is one of France's premier architecture offices. Based in Paris, the firm has delivered projects across the globe in Europe, the Middle East, Asia, Africa, Russia and Central America.

Valode&Pistre's practice focuses on very diverse scales, from developing comprehensive plans for brand new cities to designing furniture. It also includes very diverse briefs: mixed-use neighborhoods, offices, residential, hotels, retail, culture, large scale buildings (exhibition centers, stadiums, hospitals, universities) and high-rise buildings.

Our scope covers architecture, master planning, interior design and engineering (structure, façade, MEP, sustainable development).

In all of the sectors in which the firm works, its architects endeavor to transfer the contributions and innovations from one field to the other to offer renewed and novel, in-depth reflections going beyond the projects themselves. Its international experience has been an opportunity to master the most modern design tools and the highest standards of certifications related to sustainable development.



Monaco sea extension: mixed-use program, 60.000 m², under construction



Saint-Gobain Tower, Paris La Défense, France, 45.000 m², delivered 2020, highest sustainable certifications (LEED Platinum, BREEAM Outstanding, HQE Exceptionnel, EFFINERGIE+, CARE:4)

VS-A + OP-EN



VS-A SAS

41 Place Rihour
2^{ème} étage
59000 LILLE
France

Ph.: +33 (0)3 20 52 11 44

courrier@vs-a.eu

op-en@vs-a.eu

Robert-Jan VAN SANTEN

Architect, Founder & Director
Cel.: +33 (0)6 27 37 42 53
rjvs@vs-a.eu

 [vs-a-group](https://www.linkedin.com/company/vs-a-group)

www.vs-a.group

VS-A.GROUP designs and develops tailor-made building facades and envelopes. Our team gathers about 60 specialists and 9 different nationalities, working from our offices located in France, China (Hong Kong and Mainland) and Korea.

We design in collaboration on with international architectural firms, or as architects as op-en. We always look for innovative architectural and technical solutions based on common sense and adapted to local cultures.

We engineer facades with comfort and sustainability as key concerns including: zero-energy reduced carbon footprint, minimal upkeep or fit to local climate conditions. We master such topics as complex geometry, specific safety requirements, high-rise facades with all sorts of materials.

We develop cost-effective facades complying with local codes. They can be built by local or international contractors, using locally-sourced materials and products. Our design process is fully independent from suppliers to ensure best technical and financial value.

Galleria Department Store

Location: Gwanggyo, SOUTH KOREA
Architect: OMA
Client: Hanwha Galleria
GFA: 137,200 m²
Status: Completed

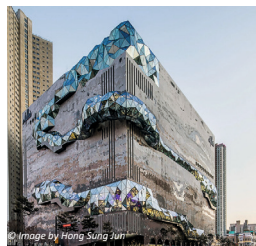

© Image by Hong Sung Jun

Confluences Museum

Location: Lyon, FRANCE
Architect: COOPHIMMELB(L)AU
Client: Rhône-Alpes Region
GFA: 22,000 m²
Status: Completed



© Image by Sergio Parrone

Qatar Foundation & National Library

Location: Doha, QATAR
Architect: OMA
Client: Qatar foundation
GFA: 71,121 m²
Status: Completed

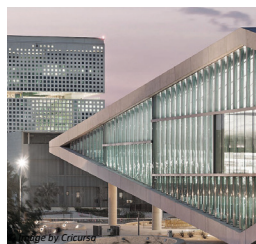

© Image by Cincursu



NOTES

A series of horizontal dotted lines for taking notes, spanning the width of the page.



PRESTATIONS D'ANCRAGE COMMERCIAL

Liste des solutions référencées

Par le biais de procédures menées dans les pays où elle dispose d'un bureau (correspondant unique Team France Export*), Business France a référencé des acteurs proposant des prestations de services liées à l'ancrage commercial, complémentaires aux missions de l'Agence et que cette dernière ne propose pas.

Dans le pays signalé ci-après, les typologies de services concernés sont : Droit et fiscalité (création de filiale, conseil) ; Administration - gestion de filiales (comptabilité, portage salarial...) ; Représentation commerciale (force de vente supplétive...) ; Hébergement, domiciliation.

Chaque prestataire référencé s'engage à faire exécuter les prestations demandées exclusivement par ses salariés et /ou ses mandataires habituels rigoureusement sélectionnés et dont il se porte garant. Il assumera seul les conséquences d'un défaut d'exécution ou d'une mauvaise exécution d'un service auquel aura fait appel une entreprise.

Pour le marché ci-dessous mentionné, Business France et, plus largement, la Team France Export*, recommandent - sans ordre de priorité - les prestataires indiqués.

Business France a obtenu auprès de certains prestataires des conditions préférentielles au profit des PME-ETI françaises orientées par la Team France Export. N'hésitez pas à leur poser la question pour en connaître les modalités.

ARABIE SAOUDITE

DROIT ET FISCALITE

HUNDT LEGAL CONSULTANCY

Contact : **Jochen HUNDT, Associé Principal**
Téléphone : +966 504233752
Mail : jochenhundt@hundtlegal.com
Adresse : PO BOX 230888, Riyadh 11321, Arabie Saoudite
Site internet : www.hundtlegal.com

LEGAL ADVISORS

Contact : **David MONNIER, Associé**
Téléphone : +966 11 265 8900 ext : 8928
Mail : david.monnier@legal-advisors.com
Adresse : PO BOX 69103, Riyadh, Arabie Saoudite
Site internet : www.legal-advisors.com

MBL LAW FIRM

Contact : **Nader EL HUSSEINI, Associé Principal**
Téléphone : +966 11 2791172
Mail : n.elhousseini@mbl-lawfirm.com
Adresse : PO BOX 66144, Riyadh 11576, Arabie Saoudite
Site internet : www.mbl-lawfirm.com

BUSINESS SEMINAR FRENCH ARCHITECTURE IN SAUDI ARABIA

▷ IN PARTNERSHIP WITH:

**AMBASSADE
DE FRANCE
EN ARABIE
SAOUDITE**
*Liberté
Égalité
Fraternité*

Architectes
Français
à l'Export

AFEX

**Baker
McKenzie.**

 **MBL**
LAW FIRM

Huidt & Partners
Legal and Business Advisory

CONTACTS

Contact in France - Head office in Paris Business France

77 Boulevard Saint-Jacques
75014 PARIS

Sébastien LAXENAIRE

Project Manager Architecture,
Construction and Sustainable Cities
Cel.: +33 (0)6 99 08 55 31
Ph.: +33 (0)1 40 73 31 15
sebastien.laxenaire@businessfrance.fr

Office Business France Riyadh Saudi Arabia

Diplomatic Quarter, P.O. Box 94009 Riyadh 11693
RIYADH
Ph.: +966 (0)11 434 41 20

Rachid BOULAOUINE

Country Director Saudi Arabia
Ph.: +966 502441157
rachid.boulaouine@businessfrance.fr

Alexandre D'ESPINOSE

Trade advisor Industry & cleantech
Ph.: +966 594 743 126
alexandre.despinose@businessfrance.fr

**TEAM
FRANCE**
—EXPORT—

BUSINESSFRANCE